



\$ 439,990

## PLAN 1715

<https://cadencenv.com>

Plan 1715 in Symmetry Bay by D.R. Horton offers 1,715 square feet of living space. This two-story home features three bedroom with an option for a fourth bedroom, 2.5 baths and a two-car garage. Homes start at \$439,990.

- 4 beds
- 2.5 baths
- DR HORTON
- 1715 sq ft



## BASIC FACTS

**Property ID:** 16269

**Bathrooms:** 2.5

**Area:** 1715 sq ft

**Square Footage:** 1715 sq ft

**Bedrooms:** 4

**Floors:** 2

**Garage Bays:** 2

## FLOOR PLANS

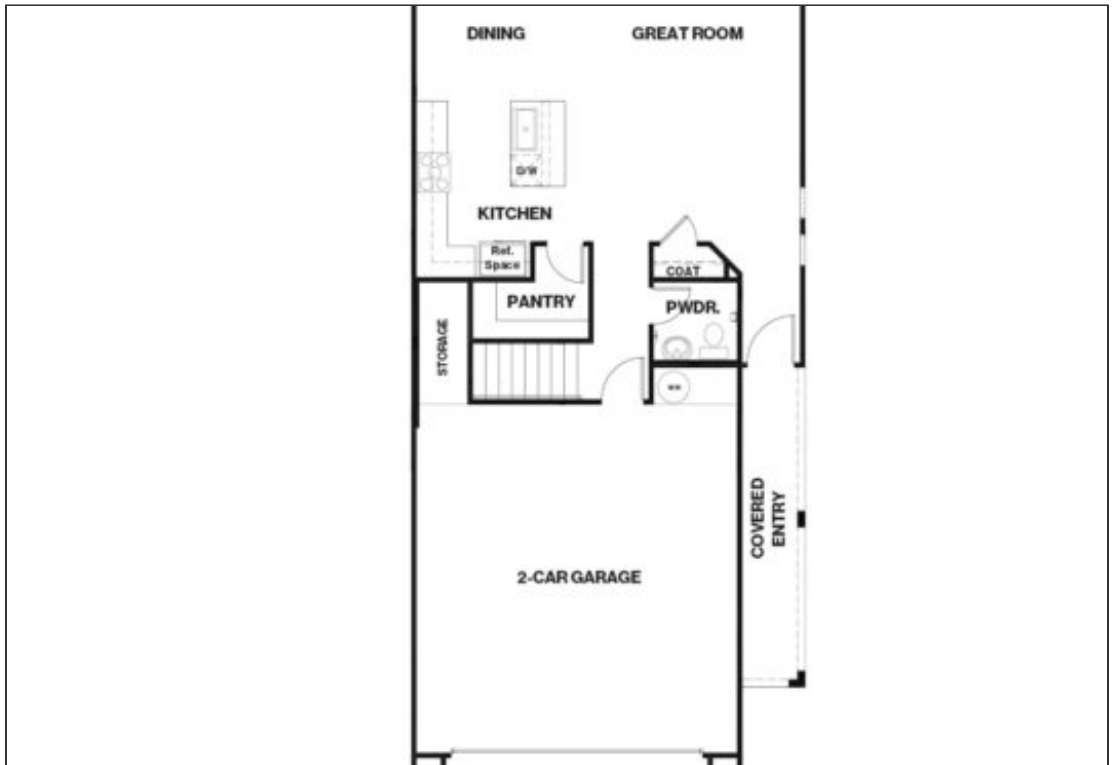

**Floor Plan 1**





Elevation A, B, D

Floor Plan 2

