



\$ 584,950

MARLOWE - QUICK MOVE-IN

<https://cadencenv.com>

This Marlowe plan (lot 64) in Adair by Woodside Homes features 2,829 square feet. Discover a home that feels open, intentional, and designed for the way life naturally unfolds. This 2,829 square foot home offers four bedrooms and three and a half baths, beginning with a private entry courtyard that...

- 4 beds
- 3.5 baths
- WOODSIDE HOMES
- 2829 sq ft



BASIC FACTS

Property ID: 26960

Bathrooms: 3.5

Area: 2829 sq ft

Square Footage: 2829 sq ft

Bedrooms: 4

Floors: 2

Garage Bays: 2

FLOOR PLANS

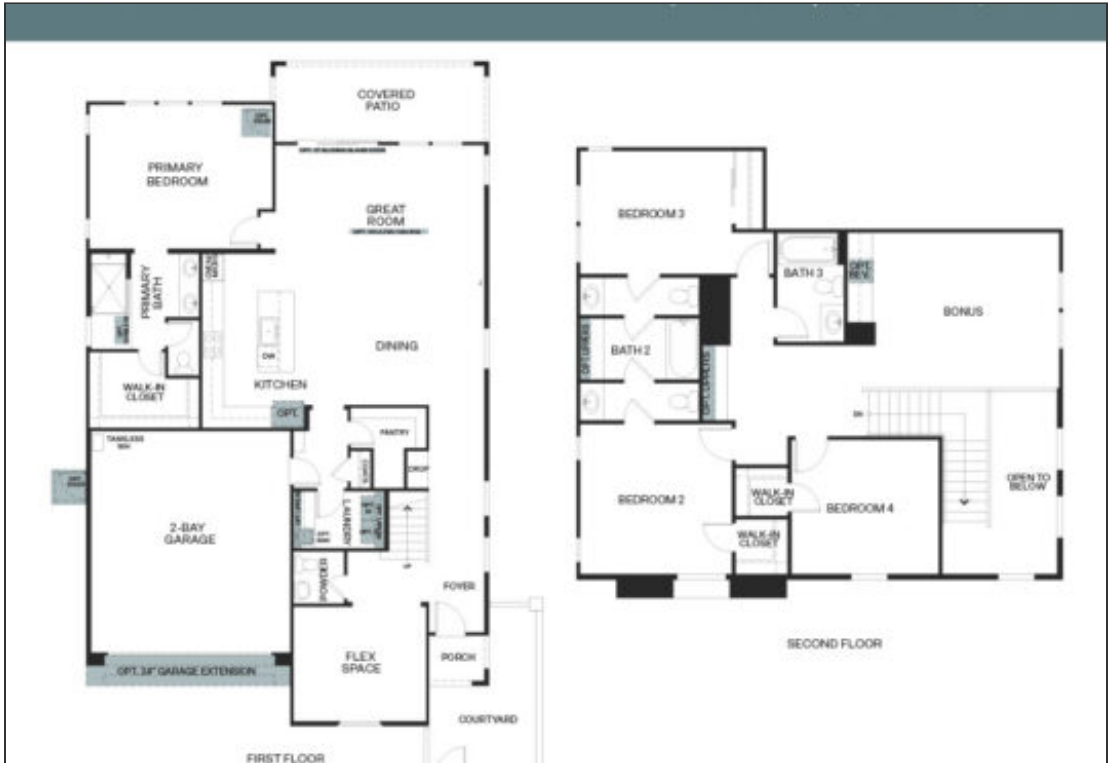

Floor Plan 1

