



\$ 513,990

## HUDSON

<https://cadencenv.com>

The Hudson plan in Piermont by Woodside Homes features 2,048 square feet of living space. This home is your retreat, a place where you can escape from the chaos and feel at peace. The Cielo Plan offers a warm, inviting atmosphere to all who enter. The three bedrooms, each with...

- 3 beds
- 3.5 baths
- WOODSIDE HOMES
- 2048 sq ft



BASIC FACTS

Property ID: 16346

Bathrooms: 3.5

Area: 2048 sq ft

Builder: WOODSIDE HOMES

Bedrooms: 3

Floors: 1

Garage Bays: 2

Square Footage: 2048 sq ft

FLOOR PLANS

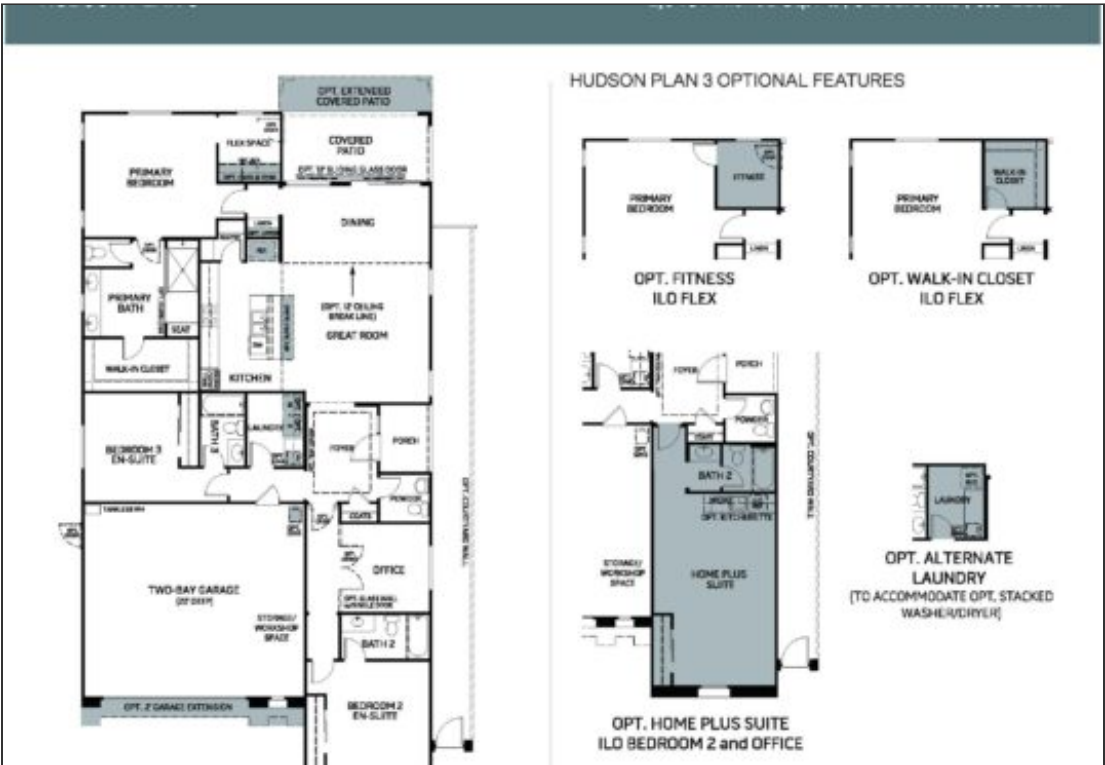

Floor Plan 1



## HUDSON PLAN 3 OPTIONAL FEATURES



OPT. DRESSING ROOM & EXPANDED LAUNDRY  
ILO BEDROOM 3 and BATH 3



OPT. PRIMARY RETREAT  
ILO BEDROOM 3 and BATH 3



OPT. GARAGE STORAGE  
ILO BEDROOM 3 and BATH 3



OPT. FULL WALL  
AT SHOWER



OPT. FREE  
STANDING TUB



OPT. DROP-IN TUB



Woodside Homes reserves the right to change floor plans, features, elevations, prices, materials and specifications without notice. All square footages and



## Floor Plan 2

