



\$ 554,950

HAWTHORN

<https://cadencenv.com>

The Hawthorn plan in Ambridge by Woodside Homes is a beautiful single-story home, located within the masterplan community of Cadence in Henderson, offers 2,080 sq ft of open living space. With three spacious bedrooms and 2.5 bathrooms, it's perfect for households seeking comfort and practicality. The home features a flex...

- 4 beds
- 3 baths
- WOODSIDE HOMES
- 2080 sq ft



BASIC FACTS

Property ID: 24432

Bathrooms: 3

Area: 2080 sq ft

Square Footage: 2080 sq ft

Bedrooms: 4

Floors: 1

Garage Bays: 2

FLOOR PLANS



Floor Plan 1





Optional Home Plus ILO Bedrooms 2 and 3



Optional Super Walk-in Closet and Laundry ILO Flex Room and Storage



Optional Extended Walk-in Closet and Laundry ILO Flex Room and Storage



Optional Bedroom 4 and Bathroom 3 ILO Flex room and Storage



Optional Freestanding Tub at Primary Bath



Optional Drop-in Tub at Primary Bath



Optional Curbleless Shower at Primary Bath

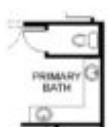

Optional Primary Bath Vanity

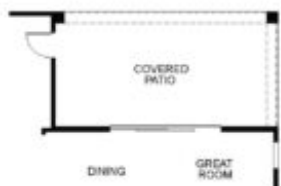

Optional Sliding Glass Door at Optional Extended Patio

Woodside Homes reserves the right to change floor plans, features, elevations, prices, materials and specifications without notice. All square footages and

Floor Plan 2

